

Truss Shoe

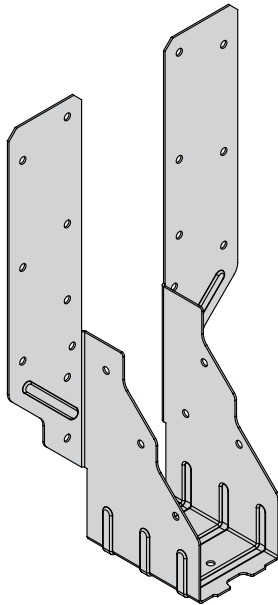

The TS hanger is designed to support trussed rafters from primary girders.

Features & Benefits

- 4 sizes available to suit standard single or double trussed rafters
- Allows design loading to be effectively transferred without local over stressing
- The high performance nail configuration minimises any direct deflection or rotation caused by the incoming truss not abutting the primary girder

Material Specification

- Galvanised mild steel - Z275

Fixings

Code	Description	Box Qty
547389	3.4 x 35mm Square Twist Nails - LOOSE	500
141185	3.4 x 35mm Square Twist Nails - COLLATED*	2,500

*For use with Paslode PPN35C

Available Sizes

Product Code	Minimum Header Depth* (mm)	Dimensions (mm)		
		(W)	(H)	(F)
TS-38	120	38	256	120
TS-50	120	50	250	114
TS-75	120	75	237	101
TS-100	89	100	225	89

**When timber depth is shallower than 'F' dimension a timber packer is required.

Nail packer to truss with 3No fixings into front ply, 3No fixings into rear ply using Paslode annular ring shank 2.8 x 63mm.

Dimensions (mm)

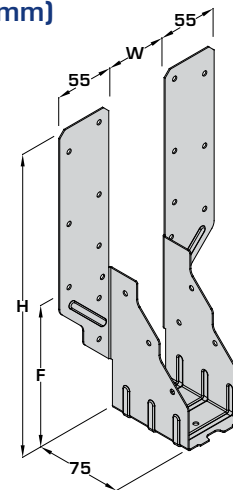

In Situ

Standard Installation:

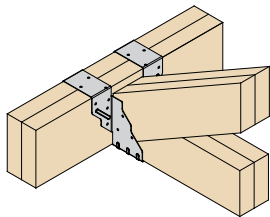

Timber depth greater than 'F' dimension

Face Fix Installation:

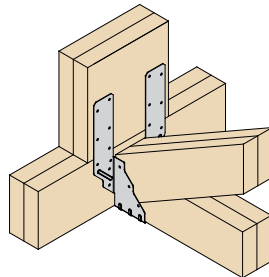

Single Leg Face Fix Installation:

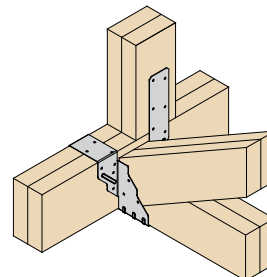

With Packer Installation**:

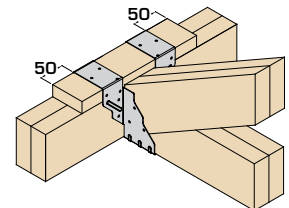

Load Data

Product Code	Fixings (3.4 x 35mm)		Safe Working Loads (kN)				Characteristic Capacity (kN)	
	Header	Incoming	Uplift - Short Term	Solid Timber Header (Min C16)			Uplift	Solid Timber Header (Min C20)
				Long Term	Medium Term	Short Term		
TS-38, TS-50, TS-75, TS-100	18	6	2.00	8.20	9.37	9.64	5.62	15.52